



Arden

The forefront of timber
windows & doors

Door and Window Solutions

Arden Windows Ltd

A British Manufacturer and Installer
of Premium Quality, Bespoke Timber
Windows and Doors.

Family Owned Since 1989





Arden Windows are the first choice fenestration partner for many main contractors and local authorities across the UK, including London Boroughs, Engie, Durkan, Taylor Wimpey, Berkeley Homes, Morris Homes, Cameron Homes and many others. We are also appointed suppliers to the LHC and WPA.

Products fully conform to current
British Building Regulations & FENSA Standards



Contents

| | |
|----------------------|----|
| Casement Range..... | 4 |
| Sliding Sash..... | 14 |
| Bespoke Windows..... | 21 |
| Door Solutions..... | 22 |
| Case Studies | 40 |
| Projects | 46 |



Casement Range



Standard Window Products

The standard window range represents 90% of all window manufacturing we undertake. These products are made to customer bespoke sizes and are factory finished in a range of RAL Colours or Stains. Additional material options include softwood, hardwood, Oak & Accoya, the addition of astragal bars, special glazing options and a choice of ironmongery. Shaped and Arched frames are also possible.



Flush Casement Windows

Flush casement windows were the hallmark of British architecture in Georgian, Victorian and Edwardian properties. Arden's offering is an authentic high-performance window manufactured in engineered timber. Fully accredited, factory glazed and finished, with an expected life cycle of 60+ years.

Storm Proof Casement

Our storm proof casement is a traditional lipped casement meaning the opening sashes lip over the front of the window frame. Our storm proof casement also has a narrower frame section than our flush casement window.



Mock Sash Casement Windows

The mock sash window is designed to replicate the aesthetics of the traditional sliding sash window. It is a cheaper alternative and allows for installation into a much shallower facade than the traditional sliding sash frame would require. Arden's Heritage Mock Sash variant was awarded "Best Product Design in Wood" by the BWF in 2018 for its innovative features.

HATHAWAY

Flush Casement Windows



- ✓ Life expectancy 60+ years
- ✓ Sustainably sourced engineered timber. Softwood or Hardwood
- ✓ Advanced environmentally responsible paint systems
- ✓ Fully factory finished & glazed
- ✓ Thermally efficient U-Values 1.0 – 1.6Wm2K
- ✓ Air permeability : Class 3
- ✓ Wind resistance : Class 5
- ✓ Water tightness : Class 6A
- ✓ Acoustic attenuation up to 42dB
- ✓ Top hung / Side hung / Shaped
- ✓ Fully reversible (Top Swing)



BS EN ISO 9001:2016



BS EN ISO 14001:2016



Secured by Design
(Optional on request)



WinMark™ Enhanced Security
(PAS24 where requested)



HATHAWAY CROSS SECTION DRAWING

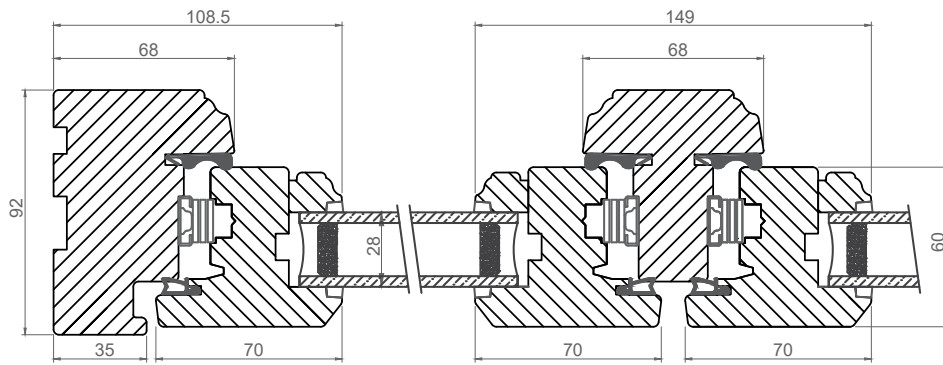

HORIZONTAL ELEVATION

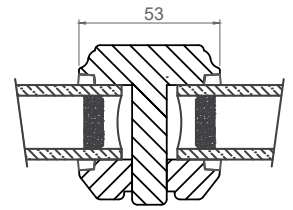

SOLID GLAZING BAR
OPTION

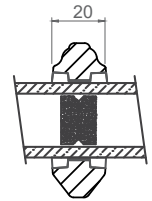

PLANT ON GLAZING BAR
OPTION

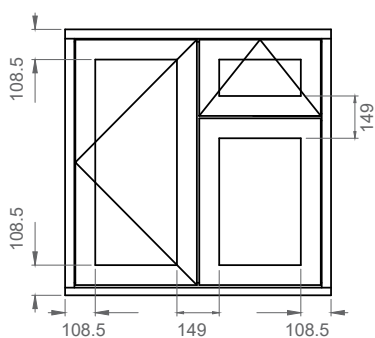
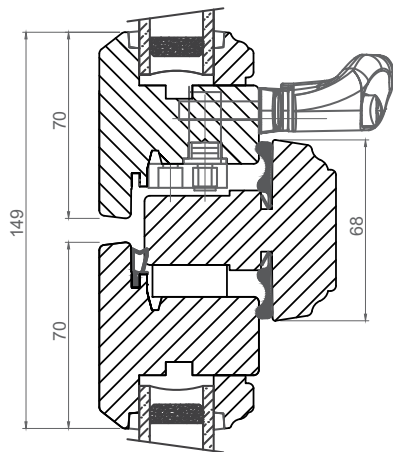

TYPICAL FRONT ELEVATION

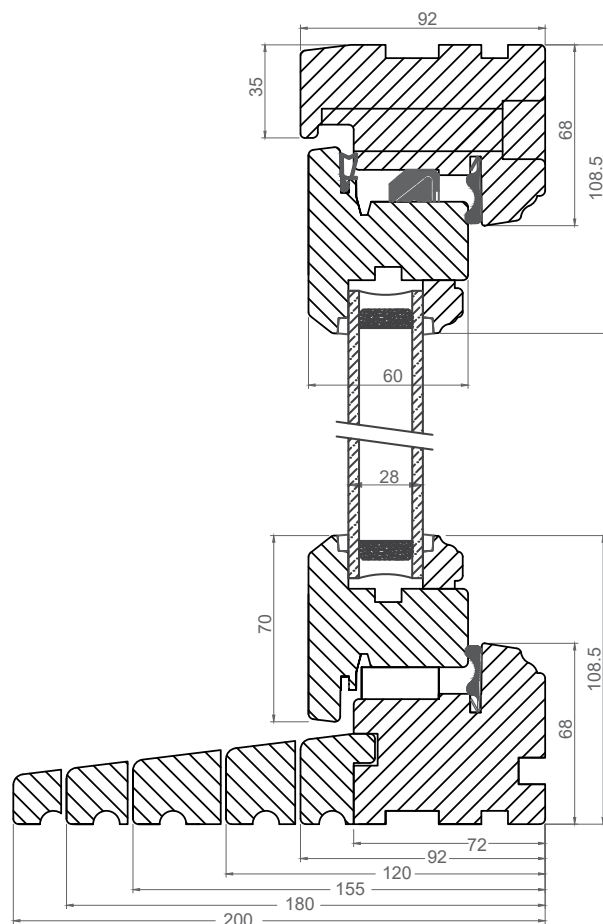

VERTICAL ELEVATION

WARWICK

Storm Proof Casement



- ✓ Life expectancy 60+ years
- ✓ Sustainably sourced engineered timber. Softwood or Hardwood
- ✓ Advanced environmentally responsible paint systems
- ✓ Fully factory finished & glazed
- ✓ Thermally efficient
- ✓ U-Values 1.0 – 1.6Wm2K
- ✓ Air permeability : Class 3
- ✓ Wind resistance : Class 5
- ✓ Water tightness : 6A
- ✓ Acoustic glazing options
- ✓ Top hung / Side hung



BS EN ISO 9001:2016



BS EN ISO 14001:2016



Secured by Design
(Optional on request)



WinMark™ Enhanced Security
(PAS24 where requested)



WARWICK CROSS SECTION DRAWING

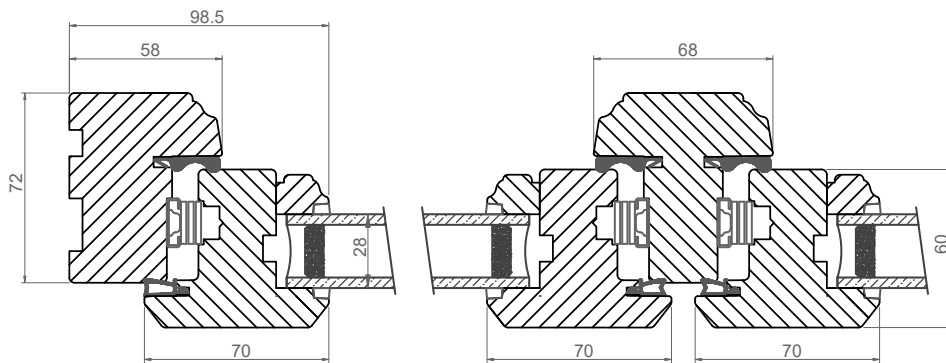

HORIZONTAL ELEVATION

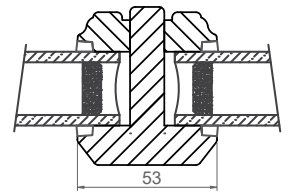

SOLID GLAZING BAR
OPTION

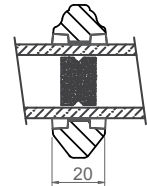

PLANT ON GLAZING BAR
OPTION

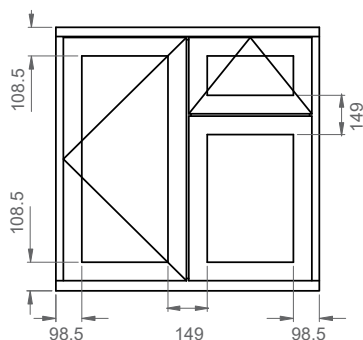
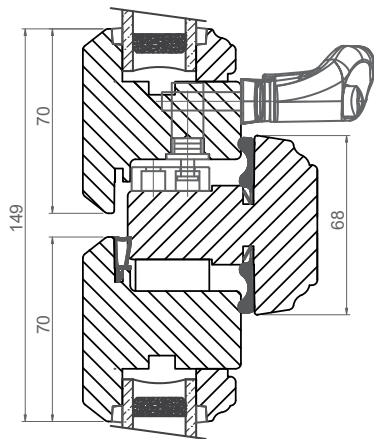

TYPICAL FRONT ELEVATION

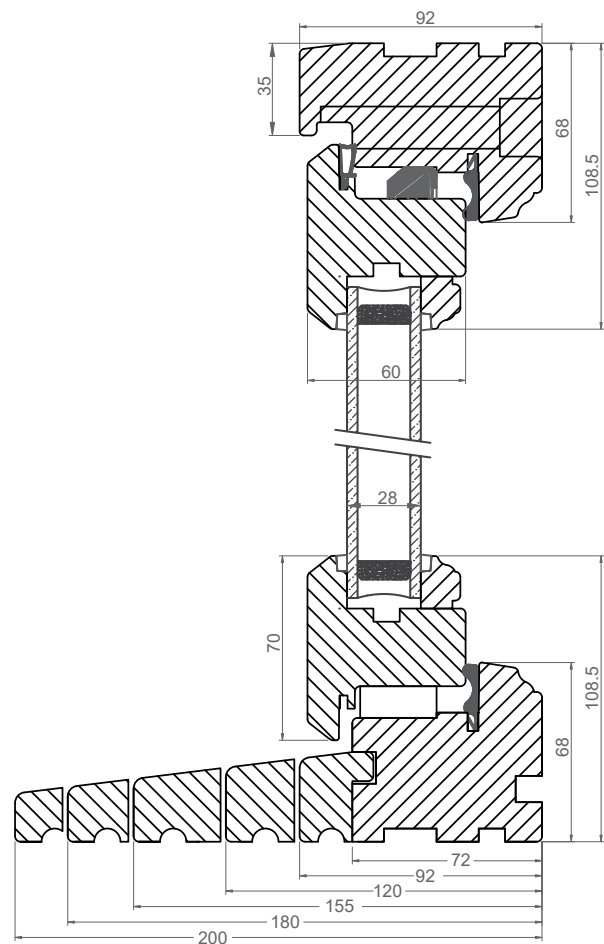

VERTICAL ELEVATION

STONELEIGH

Mock Sash Casement



- ✓ Life expectancy 60+ years
- ✓ Sustainably sourced engineered timber. Softwood or Hardwood
- ✓ Advanced environmentally responsible paint systems
- ✓ Fully factory finished & glazed
- ✓ Thermally efficient
- ✓ U-Values 1.0 – 1.6Wm2K
- ✓ Air permeability : Class 3
- ✓ Wind resistance : Class 5
- ✓ Water tightness : 6A
- ✓ Acoustic glazing options
- ✓ Top hung / Side hung
- ✓ Option for openable lower sash
- ✓ Bespoke profile & horn detailing



BS EN ISO 9001:2016



BS EN ISO 14001:2016



Secured by Design
(Optional on request)



WinMark™ Enhanced Security
(PAS24 where requested)



STONELEIGH CROSS SECTION DRAWING

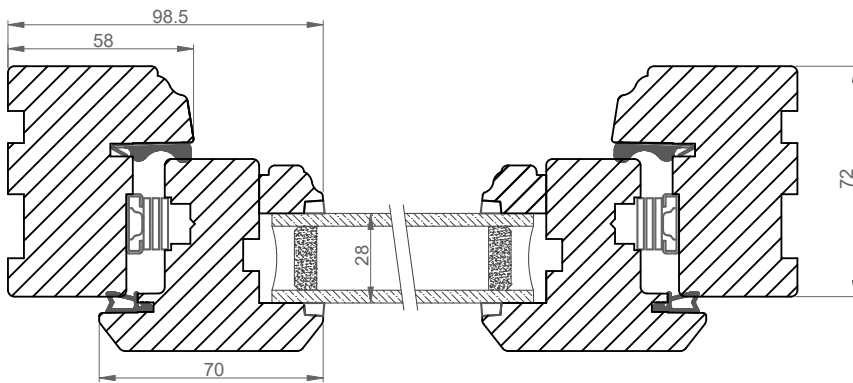

SECTION THROUGH OPENING SASH

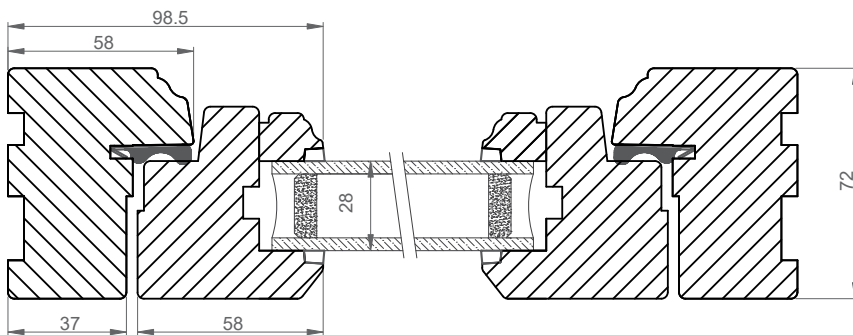

SECTION THROUGH FIXED SASH

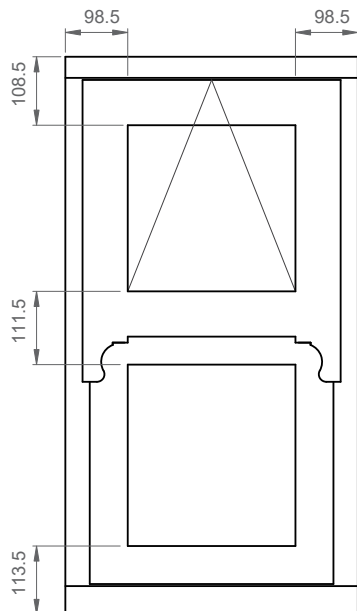

FRONT ELEVATION

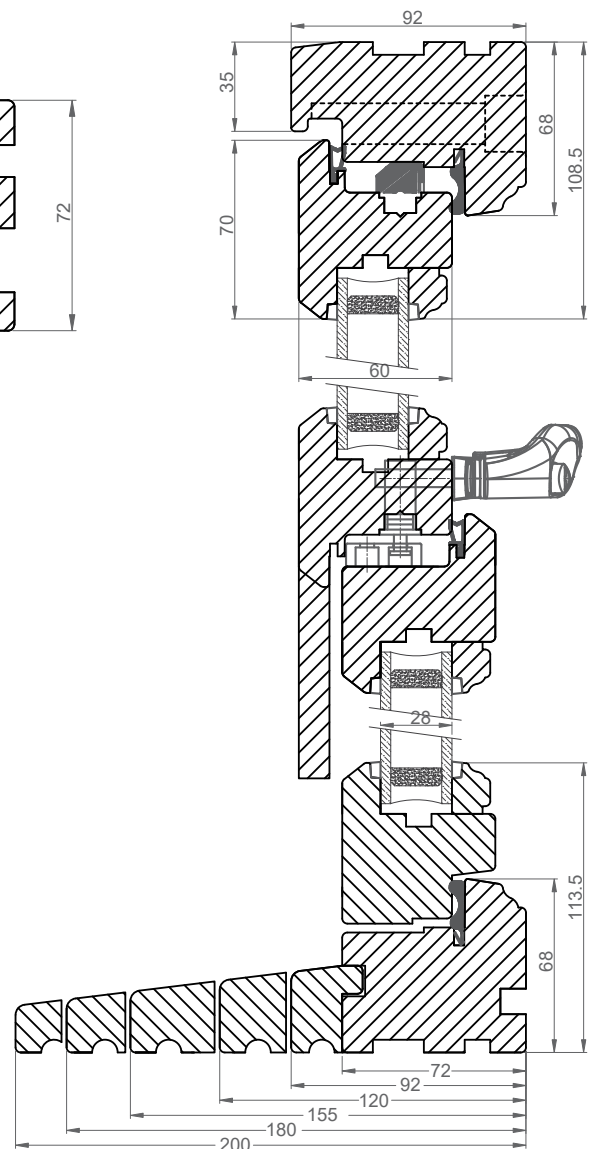

VERTICAL ELEVATION

Casement Windows Hardware

The look and feel of any window is influenced by the choice of furniture. In the creation of our window furniture collections we have focussed upon the key elements of aesthetics, quality, security and performance.

Standard Hardware Offering

Cranked



- ✓ Push to release locking mechanism
- ✓ Contoured handle for ease of use
- ✓ Endurance tested to 25,000 operations
- ✓ Champagne Gold/Chrome/Flint meet requirements of BS EN 1670 – grade 4 (240 hrs Salt Spray), Powder Coated – grade 5 (500 hrs Salt Spray)

Finishes



Premium Hardware Offering

For those seeking something more distinctive than our standard handle, we've partnered with industry-leading supplier **Hardwick** to deliver a premium range of upgrade options. Choose from the Classic and Heritage ranges, available in a variety of high-quality finishes



The Classic Range

Distinctive finishes define the Hardwick Classic Range. Every product in the range is available in each of the 6 finishes to enable a consistent look throughout the ironmongery on your project.



AB

Antique Brass



TB

Trojan Bronze



SB

Satin Brass



PB

Polished Brass



SCP

Satin Chrome Plated



CP

Chrome Plated



The Heritage Range

The Hardwick Heritage Range features a forged black finish, combining traditional styling character with the strength of solid brass for authentic period styling and modern performance.



FB

Forged Black



2050 / 2051

Hardwick Classic Lyndon Window Espag Handle

- ▶ Lockable with hex key (supplied)
- ▶ Manufactured from solid brass with matching stainless steel fixings.

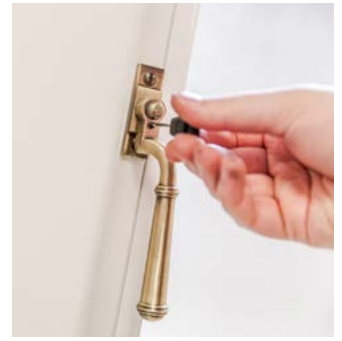

2300 / 2301

Hardwick Classic Preston Window Espag Handle

- ▶ Lockable with hex key (supplied)
- ▶ Manufactured from solid brass with matching stainless steel fixings.



2200 / 2201

Hardwick Classic Burley Window Espag Handle

- ▶ Lockable with hex key (supplied)
- ▶ Manufactured from solid brass with matching stainless steel fixings.



H500 / H501

Hardwick Heritage Curlytail Window Espag Handle

- ▶ Lockable with hex key (supplied)
- ▶ Manufactured from solid brass with matching stainless steel fixings.



H520 / H521

Hardwick Heritage Burley Window Espag Handle

- ▶ Lockable with hex key (supplied)
- ▶ Manufactured from solid brass with matching stainless steel fixings.



H550 / H551

Hardwick Heritage Lyndon Window Espag Handle

- ▶ Lockable with hex key (supplied)
- ▶ Manufactured from solid brass with matching stainless steel fixings.



H530 / H531

Hardwick Heritage Preston Window Espag Handle

- ▶ Lockable with hex key (supplied)
- ▶ Manufactured from solid brass with matching stainless steel fixings.





Sliding Sash



Sliding Sash Windows

Timber sliding sash windows have been a distinctive property feature since the 17th century and continue to be an aspirational feature in period style and executive new build properties as well in heritage, conservation areas, and listed buildings. Our versatile Kinward range is manufactured to the highest of standards, is fully accredited and can be fully modified to your project needs.

KINWARD Sliding Sash Windows



- ✓ Life expectancy 60+ years
- ✓ Sustainably sourced engineered timber.
Softwood or Hardwood
- ✓ Advanced environmentally responsible paint systems
- ✓ Fully factory finished & glazed
- ✓ Thermally Efficient U-Values 1.0 – 1.6Wm2K
- ✓ Air permeability : Class 3
- ✓ Wind resistance: Class 7A
- ✓ Water tightness : E2400
- ✓ Acoustic attenuation 32-42dB
- ✓ Spiral balance / tilt & slide or
- ✓ Traditional weights & pulleys
- ✓ Bespoke profile & horn detailing



BS EN ISO 9001:2016



BS EN ISO 14001:2016



Secured by Design
(Optional on request)



WinMark™ Enhanced Security
(PAS24 where requested)



TILT AND SLIDE

SLIDE AND TILT OPTION

TYPICAL FRONT ELEVATION

VERTICAL CROSS SECTION THROUGH WINDOW

HORN PROFILE DETAIL

HORIZONTAL CROSS SECTION THROUGH WINDOW
Q/A FRAME WIDTH

TYPICAL FRONT ELEVATION

VERTICAL ELEVATION

HORIZONTAL CROSS SECTION THROUGH WINDOW

HORN PROFILE DETAIL

The technical drawings illustrate the HORN PROFILE DETAIL. The **VERTICAL ELEVATION** shows the profile's height and width dimensions, including 164, 81, 70, 103, 103, 117, 60, 14, 60, 117, and 90. The **HORIZONTAL CROSS SECTION THROUGH WINDOW** shows the profile's width and height dimensions, including 103.5, 56, 44, 103, 60, 47.5, 63, 56, 20, 63, 103.5, 56, 44, and 117. The **HORN PROFILE DETAIL** shows the profile's cross-section with dimensions 103, 103, 117, 60, 14, 60, 117, and 90.

Sliding Sash Furniture

For our sliding sash windows we have an elegant furniture collection that provides simple, effortless operation and high security.



Standard Hardware Offering

Sash Lift



Sash Ring



Sash Fastener

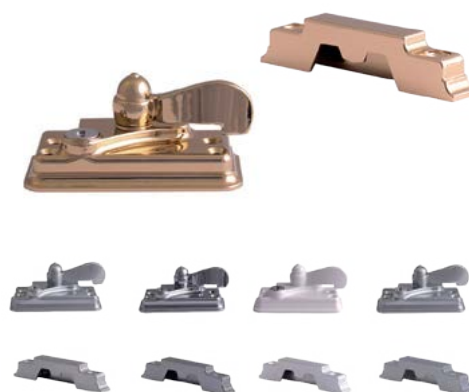

Finishes available



Premium
Satin



Hardex
Chrome



Hardex
Graphite



Hardex
Bronze



Hardex
Gold



Antique
Black



Hardex
Pewter



White



Black

Premium Hardware Offering

For those seeking something more distinctive than our standard handle, we've partnered with industry-leading supplier **Hardwick** to deliver a premium range of upgrade options. Choose from the Classic and Heritage ranges, available in a variety of high-quality finishes



The Classic Range

Distinctive finishes define the Hardwick Classic Range. Every product in the range is available in each of the 6 finishes to enable a consistent look throughout the ironmongery on your project.



AB
Antique
Brass



TB
Trojan
Bronze



SB
Satin
Brass



PB
Polished
Brass



SCP
Satin
Chrome
Plated



CP
Chrome
Plated



1075

Hardwick Classic Ball Knob Narrow Claw Fastener

- ▶ Lockable with hex key (supplied)
- ▶ Manufactured from solid brass with matching stainless steel fixings.



1077

Hardwick Classic Reeded Knob Narrow Claw Fastener

- ▶ Lockable with hex key (supplied)
- ▶ Manufactured from solid brass with matching stainless steel fixings.



1080

Hardwick Classic Narrow Fitch Fastener

- ▶ Lockable with hex key (supplied)
- ▶ Manufactured from solid brass with matching stainless steel fixings.





1056
Hardwick Classic 50mm Pulley

- ▶ Ball Bearing for smooth operation.
- ▶ Manufactured from solid brass with matching stainless steel fixings.



1085-19
Hardwick Classic Roller Stop Set

- ▶ Lockable with hex key (supplied)
- ▶ Manufactured from solid brass with matching stainless steel fixings.

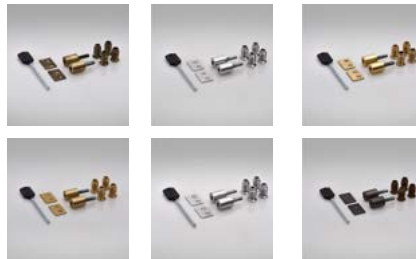

1097-19
Hardwick Classic Flush Stop Set

- ▶ Lockable with hex key (supplied)
- ▶ Manufactured from solid brass with matching stainless steel fixings.



1090
Hardwick Classic Curved Neck Sash Lift

- ▶ Manufactured from solid brass with matching stainless steel fixings.



1096
Hardwick Classic Sash Eye

- ▶ Manufactured from solid brass with matching stainless steel fixings.

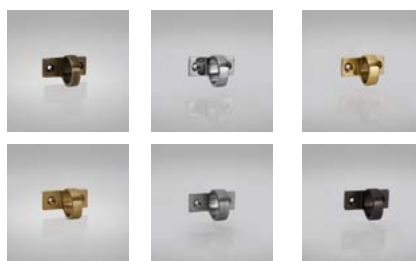

1095-132
Hardwick Classic 120mm Sash Handle

- ▶ Manufactured from solid brass with matching stainless steel fixings.

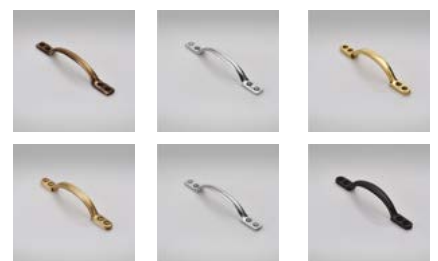

Trickle Vent Options

Trimvent® Select Xtra R16

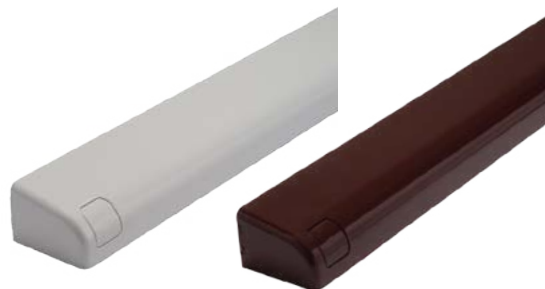

Canopy



Trickle Vent



Grille

TVA Trickle Vent



Canopy



Trickle Vent



Timber Veneer Vents

Enables vent to be finished the exact same colour and finish as your window - painted or stained.

Bespoke Windows

Whilst the standard range featured in Window Solutions covers 90% of our current manufacturing. We have an extensive range of additional products inclusive of Yorkshire Sliding Sash, Tilt and Turn, Fully Reversible, Tilt & Slide & Dual Swing windows.

Our entire range including standard products can be modified to meet customer requirements.

Designed from scratch or modified from our standard range, we can provide a truly bespoke window solution incorporating traditional or contemporary styles including unique aesthetics. Products are manufactured using a combination of cutting edge CNC and in-house skilled craftsmen.



Door Solutions



Bespoke Residential Doors

Arden Residential Doors provide a fully tailored solution whatever your requirements. We utilise highly skilled craftsmen to produce a wide range of bespoke options in the style of door of your choosing.



Single Doors

Arden's door solution represents cutting edge design combined with the latest energy efficiency and durability advantages. The aesthetic possibilities are almost infinite as we do not limit customers to a rigid range of styles. Let your imagination go wild. All doors are fully accredited and Secured by Design.

Bi-Fold Doors

Creating a seamless transition between indoors and outdoors, bi-fold doors can transform a living space. Easily installed and even easier to operate and maintain, with advanced weatherseal technology our bi-fold doors ensure an uncompromised internal environment.



Double Doors

Arden offers a comprehensive and fully accredited range of double door sets manufactured from either traditional timber sections or using contemporary timber composite blades. Doors can be modified to include fanlights and sidelights, can incorporate arched heads and are complemented by a full range of hardware options.

STRATFORD DOORS

Single Doors



- ✓ Life cycle 60+ Years
- ✓ Traditional timber construction or manufactured using contemporary timber composite blades
- ✓ Advanced environmentally responsible paint systems
- ✓ Thermally efficient U-Values as low as 1.0 Wm2K
- ✓ Air permeability : Class 3
- ✓ Wind resistance : Class 3A
- ✓ Water tightness : 4
- ✓ Fully bespoke aesthetic design
- ✓ Extensive hardware options
- ✓ Secured by design accredited
- ✓ Part M compliant



BS EN ISO 9001:2016



BS EN ISO 14001:2016



Secured by Design
(Optional on request)



WinMark™ Enhanced Security
(PAS24 where requested)



STRATFORD TECH Stratford SMART Doors

Featuring the very latest in innovative technology the doors may be unlocked using a variety of access solutions including Fingerprint, Traditional Keypad and even by using your Smart Phone. Contact us for more details.



STRATFORD SINGLE DOOR CROSS SECTION DRAWING

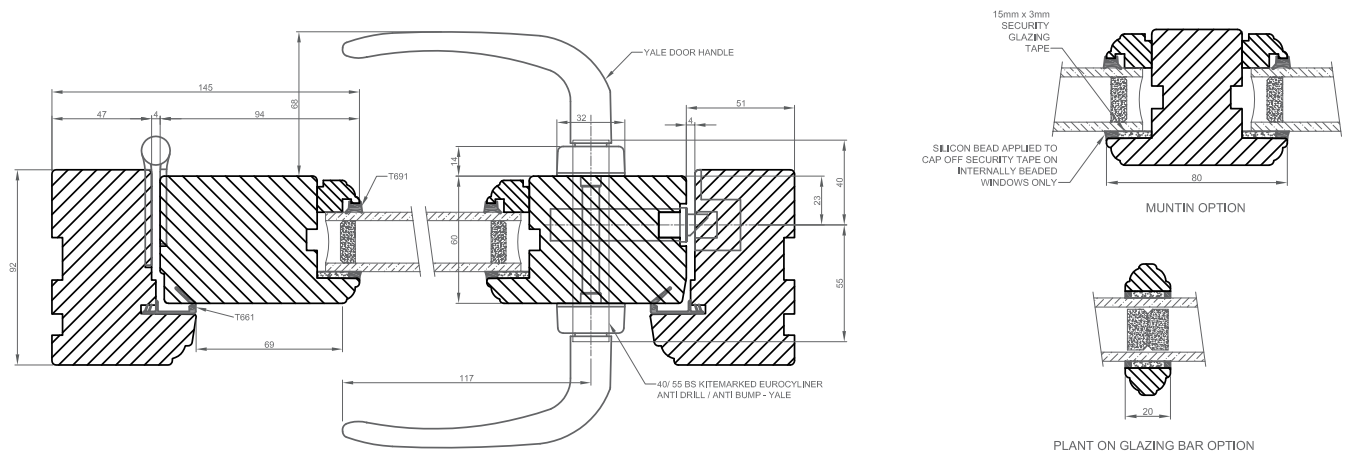

HORIZONTAL ELEVATION

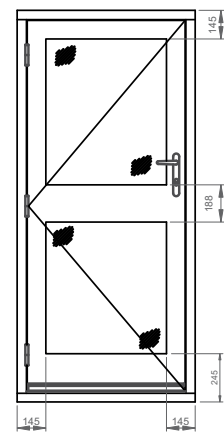

TYPICAL SINGLE DOOR ELEVATION

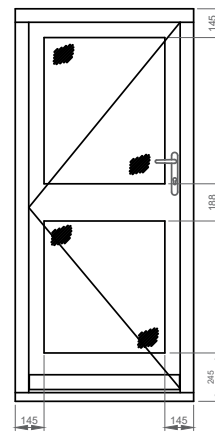
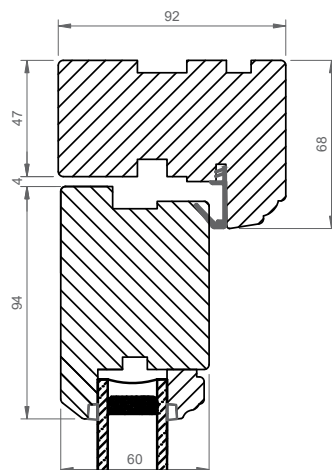

TYPICAL SINGLE DOOR ELEVATION

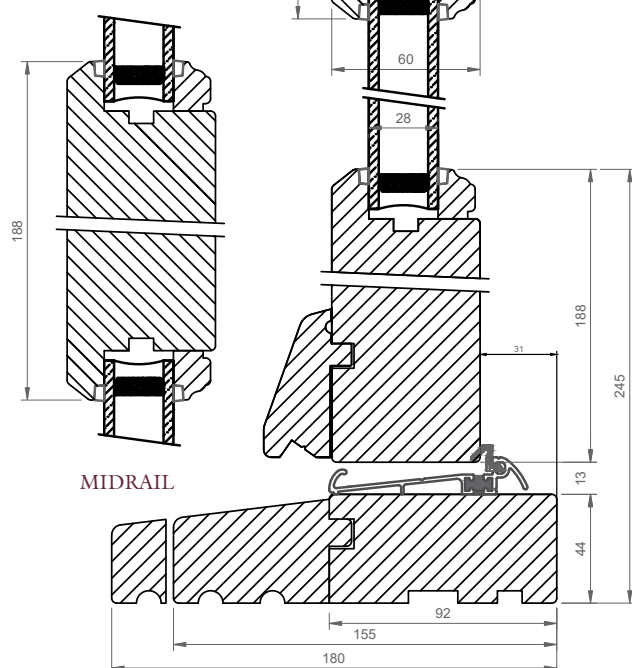
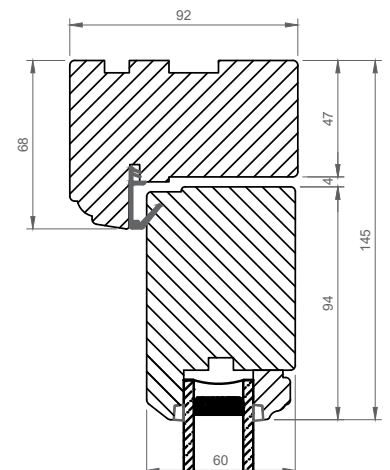

VERTICAL ELEVATION OPEN OUT

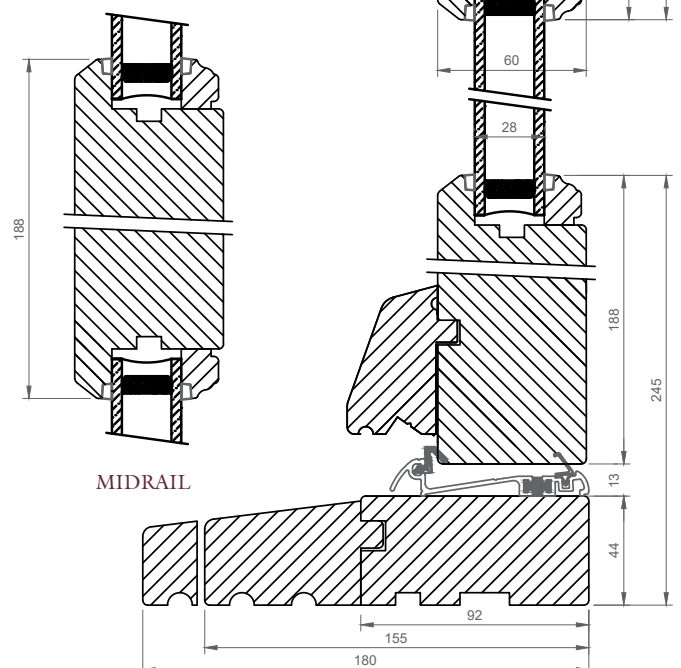

VERTICAL ELEVATION
OPEN IN

STRATFORD DOORS

Double Entrance Doors



- ✓ Life cycle 60+ Years
- ✓ Traditional timber construction or manufactured using contemporary timber composite blades
- ✓ Advanced environmentally responsible paint systems
- ✓ Thermally efficient U-Values 1.1 – 1.8Wm2K
- ✓ Air permeability : Class 3
- ✓ Wind resistance : Class 3A
- ✓ Water tightness : 4
- ✓ Fully bespoke aesthetic design
- ✓ Extensive hardware options
- ✓ Secured by design accredited



BS EN ISO 9001:2016



BS EN ISO 14001:2016



Secured by Design
(Optional on request)



WinMark™ Enhanced Security
(PAS24 where requested)



Door Design Options

Contemporary Range



C1



C2



C3



C4



C5



C6



C7



C8



Traditional Range



T1



T2



T3



T4



T5



T6



T7



T8

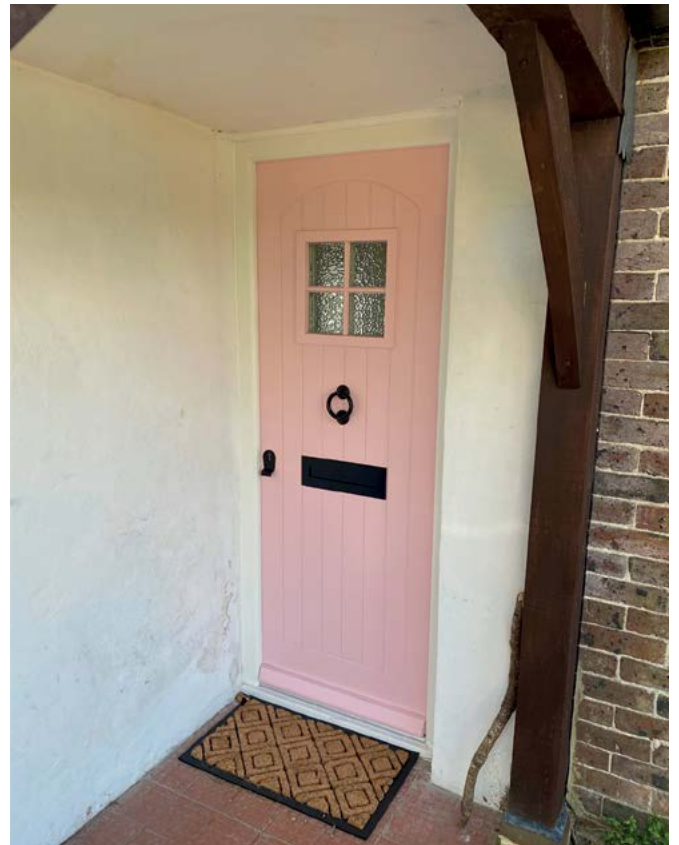

Stains and Paint Finishes

As standard our windows are finished in Ral 9016 White at a ratio of 70% Satin / 30% Gloss. Colours from the RAL chart are also available as well as a variety of stained finishes, colour matching and dual colour combinations are available on request.

Standard RAL Colour Options



RAL 9016
Traffic white
(Standard Colour offering)



RAL 9010
Pure white

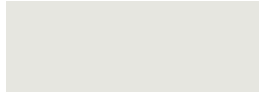

RAL 9003
Signal white



RAL 9001
Cream



RAL 1013
Oyster white



RAL 7032
Pebble grey



RAL 7012
Basalt grey



RAL 7016
Anthracite grey



RAL 9005
Jet black



RAL 8016
Mahogany brown



RAL 6021
Pale green



RAL 6013
Reed green



RAL 5013
Cobalt blue



RAL 3001
Signal red



RAL 3003
Ruby red

Note: The above images are indicative only and may not accurately reflect the exact colour of the finished product.

Painted swatches are available on request. Other colour finishes are available on request but may be subject to additional cost. Dual colour (different colour internal & external) is available at additional cost.

Wood Stains

Accoya



Base coat: 1 x Native Oak

Red Grandis

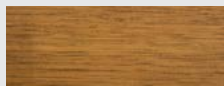

Top coat: 2 x Native Oak

European Redwood

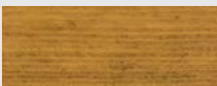

Base coat: 1 x Native Oak



Top coat: 2 x Oakwood

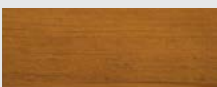

Base coat: 1 x Hazel



Top coat: 2 x Light Oak

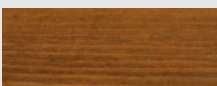

Base coat: 1 x Hazel



Top coat: 2 x Afrormosia



Base coat: 1 x Hazel



Top coat: 2 x Corkwood



Base coat: 1 x Hazel



Top coat: 2 x Makore



Accoya



Base coat: 1 x Nutwood

Red Grandis



Top coat: 2 x Afrormosia

European Redwood



Base coat: 1 x Nutwood



Top coat: 2 x Makore



Base coat: 1 x Nutwood



Top coat: 2 x Nutmeg



Base coat: 1 x Nutwood



Top coat: 2 x Spanish Cheshnut



Base coat: 1 x Nutwood



Top coat: 2 x Ebony



Note: Every effort is made to ensure the colours shown on this card are as accurate as possible, however due to the limitations of the printing process they should be considered as a guide

The colours in this colour card are based on the application of the base coat by dipping, flow-coating or saturate spraying followed by two spray-applied top coats.

Decorative Glass Range

Allow maximum light into your home whether it's for privacy or pure style with 5 different levels of privacy or obscuration.

Pilkington Texture Glass Range



Warwick™
Privacy Level 1

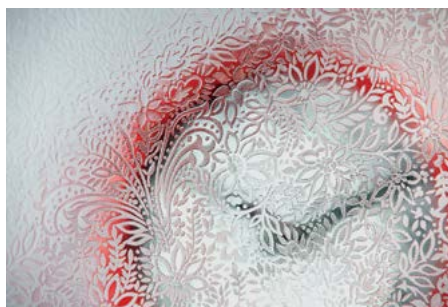

Chantilly™
Privacy Level 2



Reeded™
Privacy Level 2



Digital™
Privacy Level 3



Taffeta™
Privacy Level 3



Oak™
Privacy Level 4



Contora™
Privacy Level 4



Charcoal Sticks™
Privacy Level 4



Florielle™
Privacy Level 4



Mayflower™
Privacy Level 4

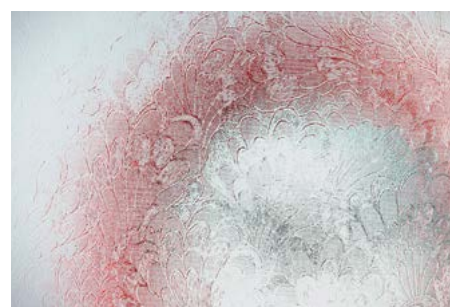

Pelerine™
Privacy Level 4

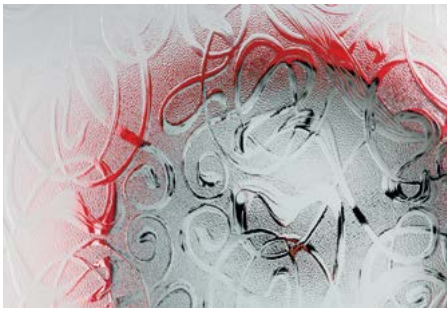

Everglade™
Privacy Level 5

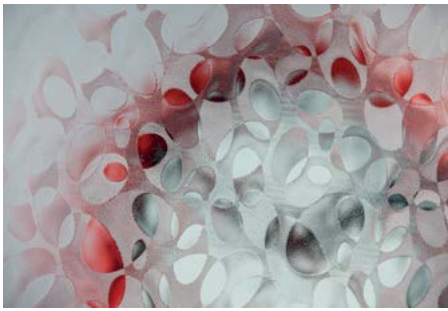

Cassini™
Privacy Level 5



Tribal™
Privacy Level 5

Pilkington Replacement Texture Glass Range



Flemish™
Privacy Level 1



Minster™
Privacy Level 2



Sycamore™
Privacy Level 2



Autumn™
Privacy Level 3



Stippolyte™
Privacy Level 4



Arctic™
Privacy Level 5



Cotswold™
Privacy Level 5

Front Entrance Door Furniture



Standard Hardware Offering

Lever Handle



Finishes available



Letterplate

Perfectly mix and match to suit interior and exterior door finishes



Internal Letterplate



External Letterplate



Premium Hardware Offering

For those seeking something more distinctive than our standard handle, we've partnered with industry-leading supplier **Hardwick** to deliver a premium range of upgrade options. Choose from the Classic and Heritage ranges, available in a variety of high-quality finishes



The Classic Range

Distinctive finishes define the Hardwick Classic Range. Every product in the range is available in each of the 6 finishes to enable a consistent look throughout the ironmongery on your project.



AB

Antique
Brass



TB

Trojan
Bronze



SB

Satin
Brass



PB

Polished
Brass



SCP

Satin
Chrome
Plated



CP

Chrome
Plated

The Heritage Range

The Hardwick Heritage Range features a forged black finish, combining traditional character with the strength of solid brass for authentic period styling and modern performance.



FB

Forged
Black

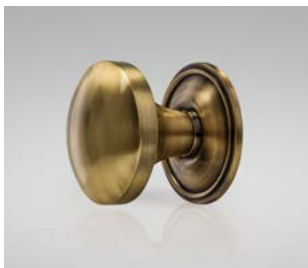

4100
Hardwick Classic Ryhall Centre
Door Knob

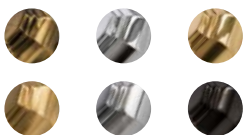

4110
Hardwick Classic Ayston Centre
Door Knob

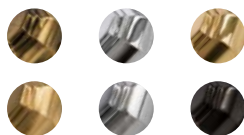

4100
Hardwick Classic Hambleton
Centre Door Knob

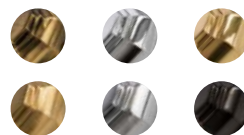

4220
Hardwick Classic Bumblebee
Door Knocker

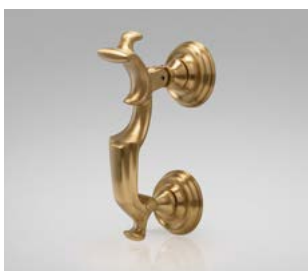
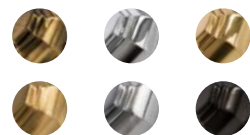

4200
Hardwick Classic Ryhall Doctors
Door Knocker

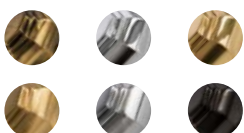

4210
Hardwick Classic Ayston Ring
Door Knocker

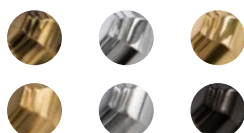

4350
Hardwick Classic Sleeved
Letterbox

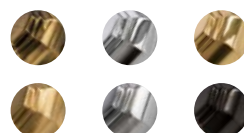

4352
Hardwick Classic Sleeved
Letterbox "LETTERS" Embossed

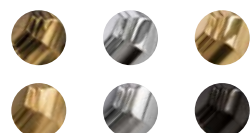



3050

Hardwick Classic Lyndon Door Lever for Multipoint Lock

- ▶ Smooth operating dual-action spring cassette in backplate.
- ▶ Manufactured from solid brass with matching stainless steel fixings.



Also available in the Heritage Range:

H630 Hardwick Heritage Lyndon Door Lever for Multipoint Lock



3300

Hardwick Classic Preston Door Lever for Multipoint Lock

- ▶ Smooth operating dual-action spring cassette in backplate.
- ▶ Manufactured from solid brass with matching stainless steel fixings.



Also available in the Heritage Range:

H620 Hardwick Heritage Preston Door Lever for Multipoint Lock



3200

Hardwick Classic Burley Door Lever for Multipoint Lock

- ▶ Smooth operating dual-action spring cassette in backplate.
- ▶ Manufactured from solid brass with matching stainless steel fixings.



Also available in the Heritage Range:

H600 Hardwick Heritage Burley Door Lever for Multipoint Lock



3100 / 3101

Hardwick Classic Cottesmore Door Lever for Multipoint Lock

- ▶ Smooth operating dual-action spring cassette in backplate.
- ▶ Manufactured from solid brass with matching stainless steel fixings.

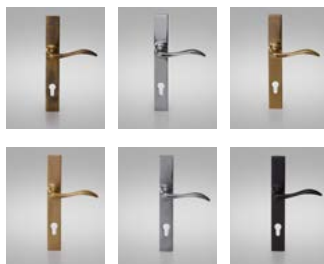

H610

Hardwick Heritage Brooke Door Lever for Multipoint Lock

- ▶ Smooth operating dual-action spring cassette in backplate.
- ▶ Manufactured from solid brass with matching stainless steel fixings.



Contemporary Range

THE CONTEMPORARY SUITE FOR LEVER OPERATED DOORS

This suited range is for those who want modern styling but need a lever handle to operate their multipoint lock.



Ergonomic on Backplate



Mitre on Backplate



Mitre on Slimline Backplate

THE CONTEMPORARY SUITE FOR NON-LEVER OPERATED DOORS

For those who want modern styling with key operated or slam shut lock on their door. Pull handles are particularly useful for heavy doors.



Pull Handle Option



Inline Round
'T' Bar

Sizes available

- ✓ 400mm
- ✓ 600mm
- ✓ 900mm
- ✓ 1200mm
- ✓ 1500mm
- ✓ 1800mm



Offset Round
'T' Bar

Sizes available

- ✓ 400mm
- ✓ 545mm
- ✓ 600mm
- ✓ 900mm
- ✓ 1200mm
- ✓ 1500mm
- ✓ 1800mm



Inline Rectangular
'T' Bar

Sizes available

- ✓ 400mm
- ✓ 900mm
- ✓ 1200mm
- ✓ 1500mm
- ✓ 1800mm



Offset Rectangular
'T' Bar

Size available

- ✓ 1200mm



Square Mitre

Size available

- ✓ 900mm
- ✓ 1200mm

Escutcheon Option

SSS

MBL



KM045 - Oval Escutcheon

SSS

MBL



KM080 - Rectangular Escutcheon

SSS



SE40 - SecurityOval Escutcheon

SSS

MBL



KM056 - Square Escutcheon

SSS

MBL



KM055 - Round Escutcheon

SSS



SE38 - Security Round Escutcheon

Suited Door Furniture



LP400 Sleeve Letter Plate



DKB155 Door Knocker



Numerals & Letters



STRATFORD DOORS

Bi-Fold Doors



- ✓ Life expectancy 60+ Years
- ✓ Sustainably sourced engineered timber Softwood or Hardwood
- ✓ Advanced environmentally responsible paint systems
- ✓ Fully factory finished & glazed
- ✓ Featuring market leading hardware supplied by Centor®
- ✓ Air permeability : Class 3
- ✓ Wind resistance : Class C3
- ✓ Water tightness : 5A
- ✓ Thermally efficient double glazing
- ✓ Part L compliant
- ✓ Timber / aluminium or DTS cills



BS EN ISO 9001:2016



Secured by Design
(Optional on request)



BS EN ISO 14001:2016



WinMark™ Enhanced Security
(PAS24 where requested)

Bi-Fold Door Configurations

Typical Bi Fold opening configurations, from two leaves upwards, include multiple left (L) and right (R) hand options

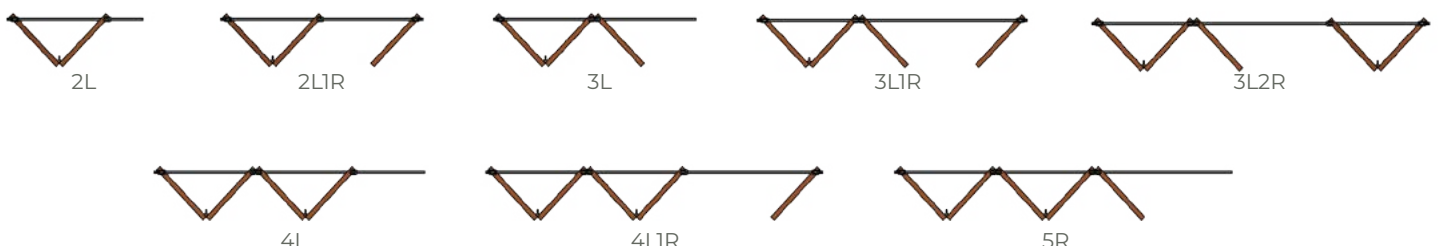

STRATFORD BI-FOLD DOOR CROSS SECTION DRAWING

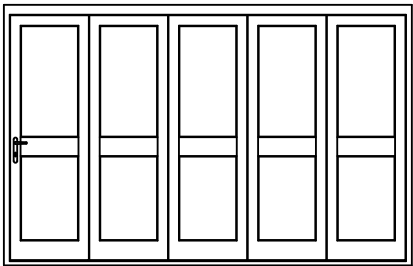

TYPICAL ELEVATION SHOWING FIVE LEAF
VARIATION

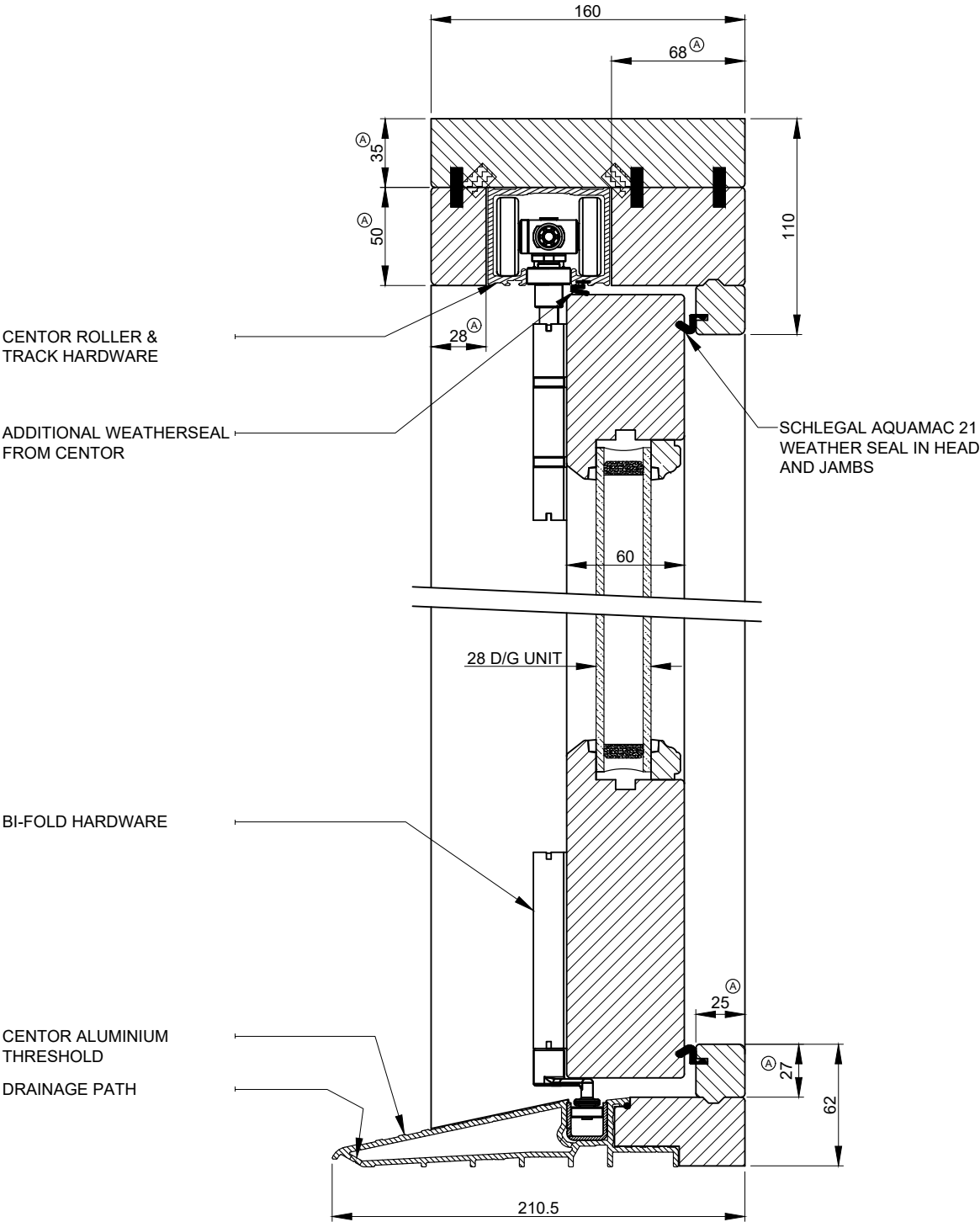

VERTICAL ELEVATION

Sliding Patio Doors

Available in 2, 3 and 4 panel configurations with a wide range of energy-efficient glazing options and decorative grilles. Standard 2-panel patio doors are available in 5', 6' and 8' widths with two height options. Custom sizes are available upon request.

Opening Configurations



Premium Patio Sliding Door Handle Option

Contemporary, high quality lift and slide handles for patio doors with unique 2-stage click action for superior operation.



PATIO LIFT AND SLIDE SECTION

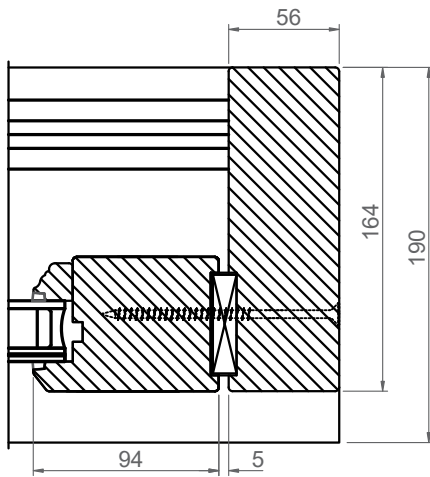

FIXED DOOR TO JAMB

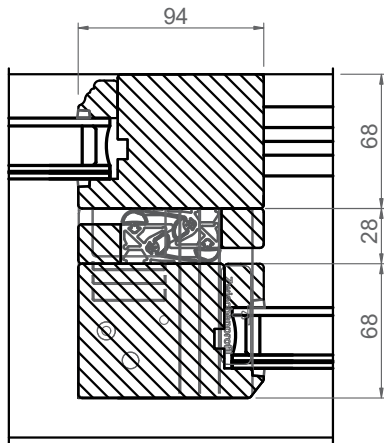

INTERLOCKING STILES

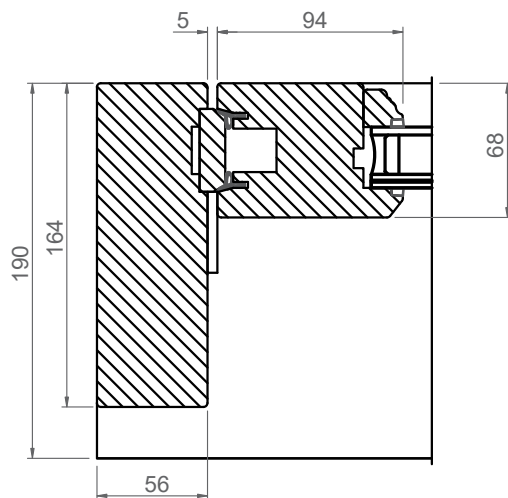

SLIDING DOOR LOCKING

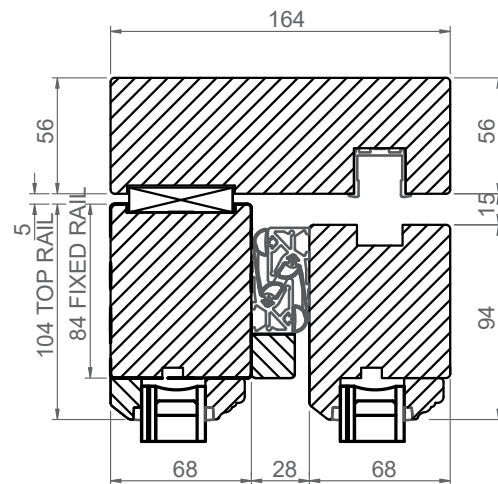

HEAD SECTION
FIXED / SLIDING DOOR

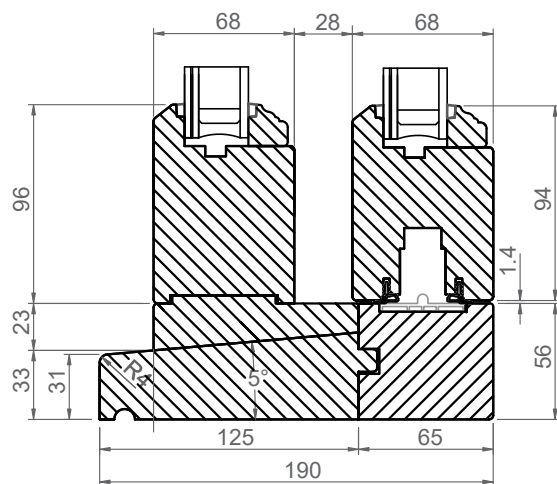

BTM RAIL DOOR
FIXED / SLIDING CILL

Case Studies



Arden Windows – The First Virtually Plastic Free Homes

Arden Windows Ltd were trusted to supply Green Square Accord the timber windows for the UK's "first virtually plastic free Homes"

The UK takes a significant step towards sustainable living with the introduction of its first plastic-free homes, setting a new benchmark for eco-friendly construction and design. Spearheaded by innovative developers and sustainability advocates, these pioneering homes are designed to minimise plastic usage throughout their construction and daily operation, offering residents a greener and healthier living environment.



The introduction of the UK's first plastic-free homes marks a significant milestone in the journey towards sustainable living. By demonstrating that it's possible to build attractive, comfortable, and functional homes without relying on plastic, these pioneering projects are paving the way for a greener and more sustainable future. As more people become aware of the benefits of plastic-free living, we can expect to see continued growth and innovation in this exciting field.



Samuel Lewis Housing Trust, Fulham

Bespoke sliding sash window replacement scheme

| | |
|-------------------|------------------------------|
| Client | Southern Housing Association |
| Contractor | Durkan Limited |
| Product | Bespoke Sliding Sash Windows |

The buildings at Lisgar Terrace in Fulham are one of many Samuel Lewis Housing Trust Estates in the London area, each comprising of a solid brick structure characterised by large chimney stacks and high cornices.

Samuel Lewis was a Victorian philanthropist who earned his fortune through finance and money-lending. On his death in 1901 he left an endowment of £670,000 to set up a charitable trust to provide housing for the poor.

The blocks at Lisgar Terrace were built in 1927 and are a fine example of Victorian architecture, although the timber sliding sash



windows which were nearly 100 years old were in need of replacement.

Durkan were appointed by Southern Housing Group to undertake a £30m refurbishment of the estate a number of years ago.

Arden worked with the architect to design a bespoke solution for the windows that met the aesthetic, thermal, and security requirements of the project. Samples were manufactured and approved by the client and conservation officer and Arden supplied the windows to the first four phases, which were installed by others.

In late 2019 having proven the product quality and manufacturing capability throughout the supply of products to the first phases, Arden tendered for and were subsequently appointed by main contractor Durkan to undertake the full sub-contract supply and installation of windows and a number of doors to Phase 5 of the window replacement works. Work commenced on site in March 2020 and despite the challenges of programme revisions, supply chain disruption and site closures due to the Pandemic; the project was completed on time and within budget.

This major project further strengthens Arden's position as a leading sub-contract manufacturer and installer of bespoke timber windows and doors in the capital, this being one of a number of major projects they are undertaking in 2020 – 2021.





Stunning Development from Morris Homes

Conservation Windows and Doors

| | |
|-------------------|---|
| Client | Burghley House Preservation Trust |
| Contractor | Morris Homes |
| Product | Bespoke Sliding Sash Windows / Residential Doors / French Doors |

Cecil Square contains 45 homes on a 1.5-hectare site in Stamford which was formally the location of Stamford AFC football club. It is a well-planned development of executive homes, founded upon the strong principles of good quality urban design and environmental sustainability.

With its long history, spectacular town centre, and vibrant sense of community, Stamford is a special place in which to live and work. The local authorities, landowners, developers and other stakeholders all acknowledged there was a challenge and a responsibility to help this much-cherished town grow and meet the needs of its current and future residents.

The client, Burghley House Preservation Trust entrusted Adam Architecture and housebuilder Morris Homes to bring their vision and values to reality, resulting in a stunning development completed in late 2019.

Following a thorough tendering process including assessment of quality, environmental, technical capability and accreditations by the client, architect and the developer, Arden windows were selected as the preferred supplier and installer of the timber window and door package. Products supplied include timber sliding sash windows, flush casement windows, and double and single residential doors.



The bespoke window and door designs supplied by Arden achieve the requirements of the traditional aesthetics essential in such a key location, thus ensuring that the new development is in keeping with the local architecture. In addition to meeting this requirement, all products were manufactured within an IOS9001 Quality Management System, are fully certified to all current UK building regulations and are secured by design accredited.

Arden undertook the full sub-contract supply and installation of the window and door package which was managed directly by their contracts director and installation teams.







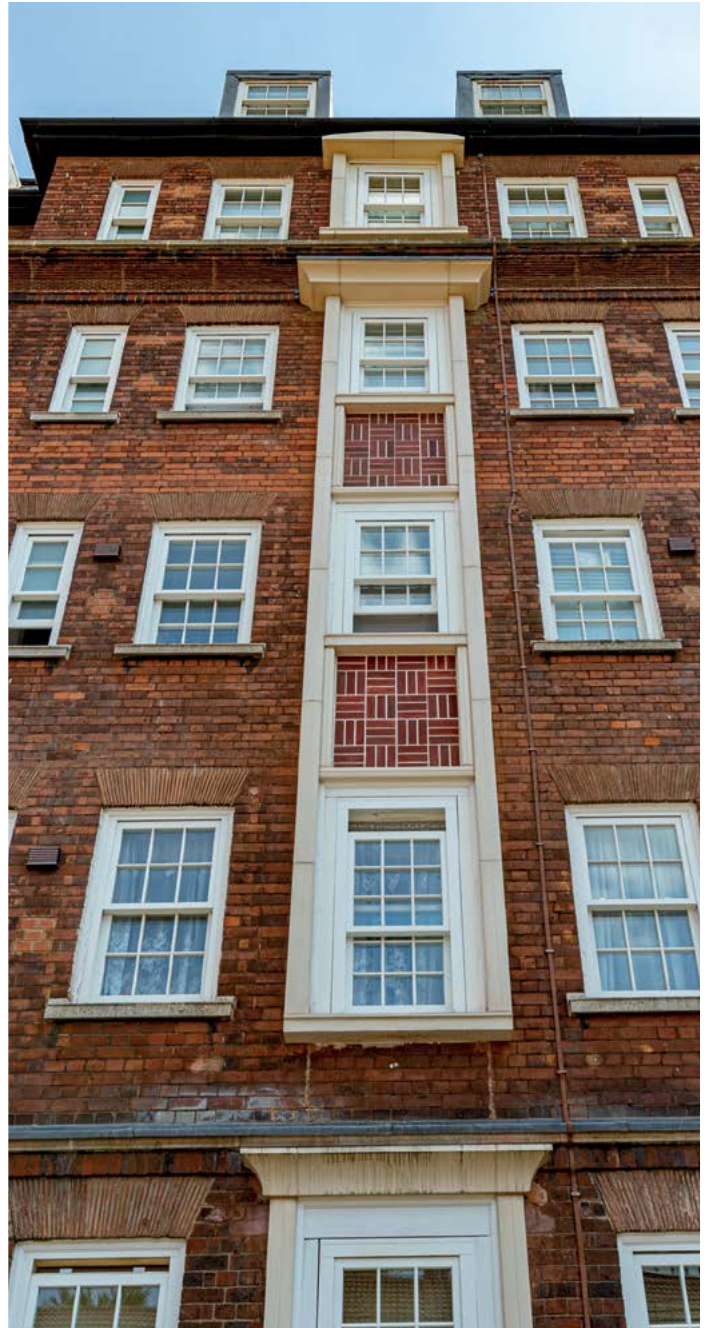

Arden | The forefront of timber
windows & doors

Arden Windows Ltd

Arden House, Sparkbrook Street, Coventry, CV1 5ST

T 02476 632423 **E** info@ardenwindows.net **W** ardenwindows.net